

UNCONTROLLED WHEN PRINTED, CHECK REVISION AND STATUS BEFORE USE

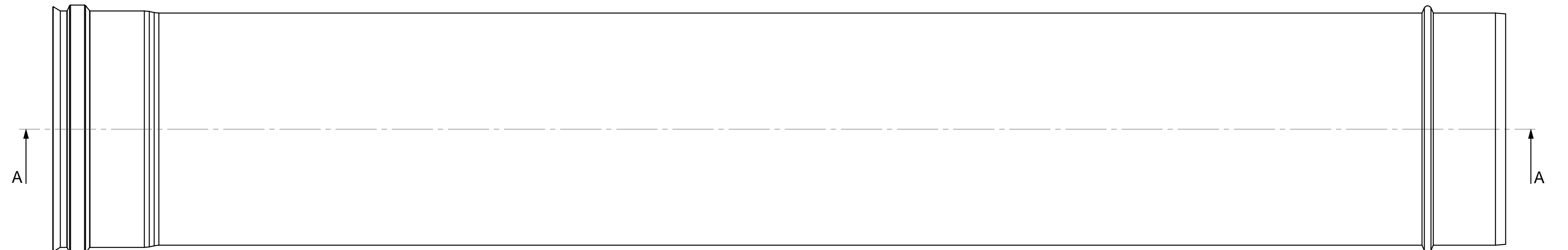
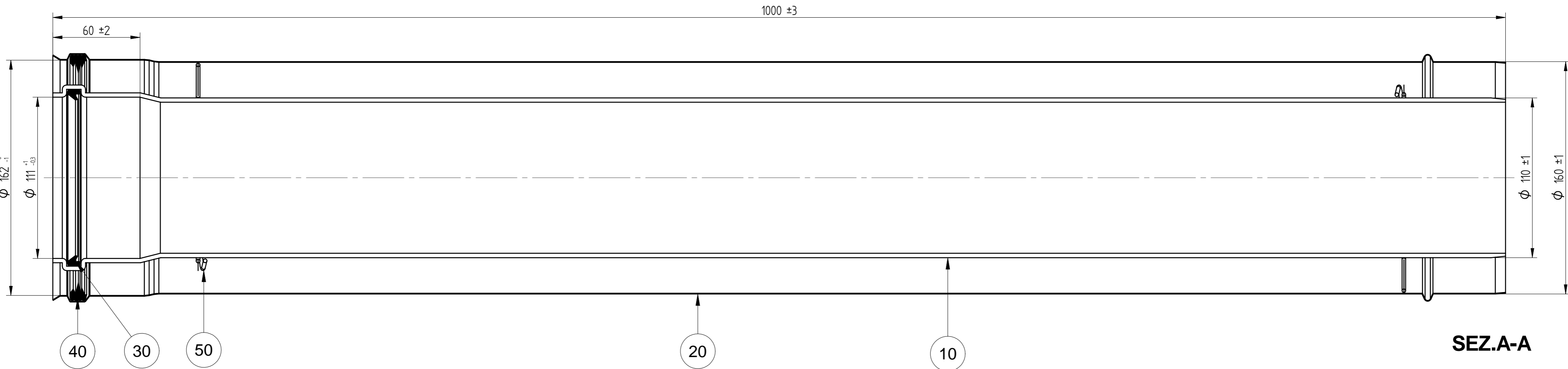

CODICE DISEGNO FORNITORE : 63232855
 CODICE ARTICOLO FORNITORE: 939382530

ITEM NO	PART NUMBER	DESCRIPTION	QTY
70	926.710.1	ETICHETTA IDENTIFICAZIONE KIT KUG714133810	1
60	XXXXXX	SCATOLA IMBALLO KIT 1020x190x190	1
50	XXXXXX	MOLLA A FILO Ø 110/160 mm	2
40	54.1262.1	GUARNIZIONE Ø 160 MM EPDM OMOLOGATO	1
30	34.0221.1	GUARNIZIONE Ø 110 MM EPDM OMOLOGATO	1
20	XXXXXX	TUBO Ø 160X1X1000 M-F COLORE BIANCO RAL 9003	1
10	XXXXXX	TUBO Ø 110X3X1000 M-F PP COLORE GRIGIO RAL 7037	1

CODICE PRODOTTO FINITO CONFEZIONATO BAXI: KUG714133810

ETICHETTA INDICATIVA A CURA DEL FORNITORE
 DISEGNO NON IN SCALA

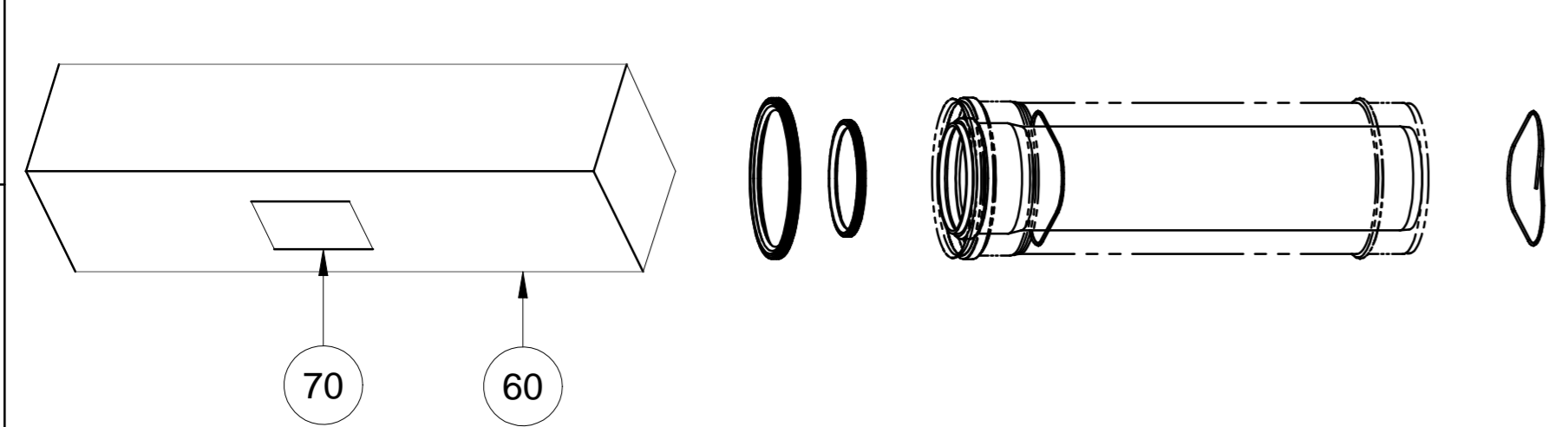

DISEGNO SCATOLA E PARTICOLARE NON IN SCALA

■ Ø 110/160 mm L=1000 EXTENSION FLUE
 ■ ROHR L=1000 Ø 110/160 mm
 ■ TUBE L=1000 Ø 110/160 mm
 ■ TUBO L=1000 Ø 110/160 mm
 ■ TUBO L=1000 Ø 110/160 mm
 ■ TUBE L=1000 Ø 110/160 mm
 ■ TUBO L=1000 Ø 110/160 mm

codice a barre tipo C39 vedi KUG71.....
 "KUG714133810"

926.710.1

BAXI S.p.A.
 A MEMBER OF BAXI GROUP

Production
 ENGINEER: DALLA COSTA MAURO

ITEM NUMBER: 570469
 DATE: 09-Dec-09

REVISION: 01
 SHEET No. 1 of 1

TITLE: TUBO COAS. L 1000 D.110-160 MM
 MATERIAL SPECIFICATION:

CLASS m	0.5-3	3-6	6-30	30-100	100-400	400-1600
LINEAR	±0.1	±0.1	±0.2	±0.3	±0.5	±0.8
RADI & CHAMFERS	±0.4	±1	±1			
CLASS m	0.5-3	3-6	6-30	30-100	100-400	400-1600
ANGULAR	±1*	±1*	±1*	±1*	±1*	±1*

FIRST ANGLE PROJECTION:

TOLERANCE TO EN 22768 - mK UNLESS OTHERWISE SPECIFIED

QUALITY SIGNIFICANCE: [C]=CRITICAL [I]=IMPORTANT
 ITEM CATEGORY (1, 2 OR 3) **3** **A2**